

JUMPER SETTINGS FOR MODEL: TR5

- ① **Turn off and unplug the chiller.**
- ② **Remove shut off valves by unscrewing ring nuts. Remove housing ring nut and gaskets.** You may need to use a wrench or pliers to loosen the ring nuts, we recommend placing a cloth over the ring nut to prevent damage to the plastic.
- ③ **Pull out the air filter. Unscrew and remove screws on the bottom.** Use a phillips head screwdriver. You may have to move the chiller to the edge of a table to do this.
- ④ **Remove the housing.** Housing will remain attached to chiller via electric cables. Grasp the bottom of the chiller and the edge of the power socket, pull up and turn housing over and to the side. Do not operate the chiller until housing is replaced.

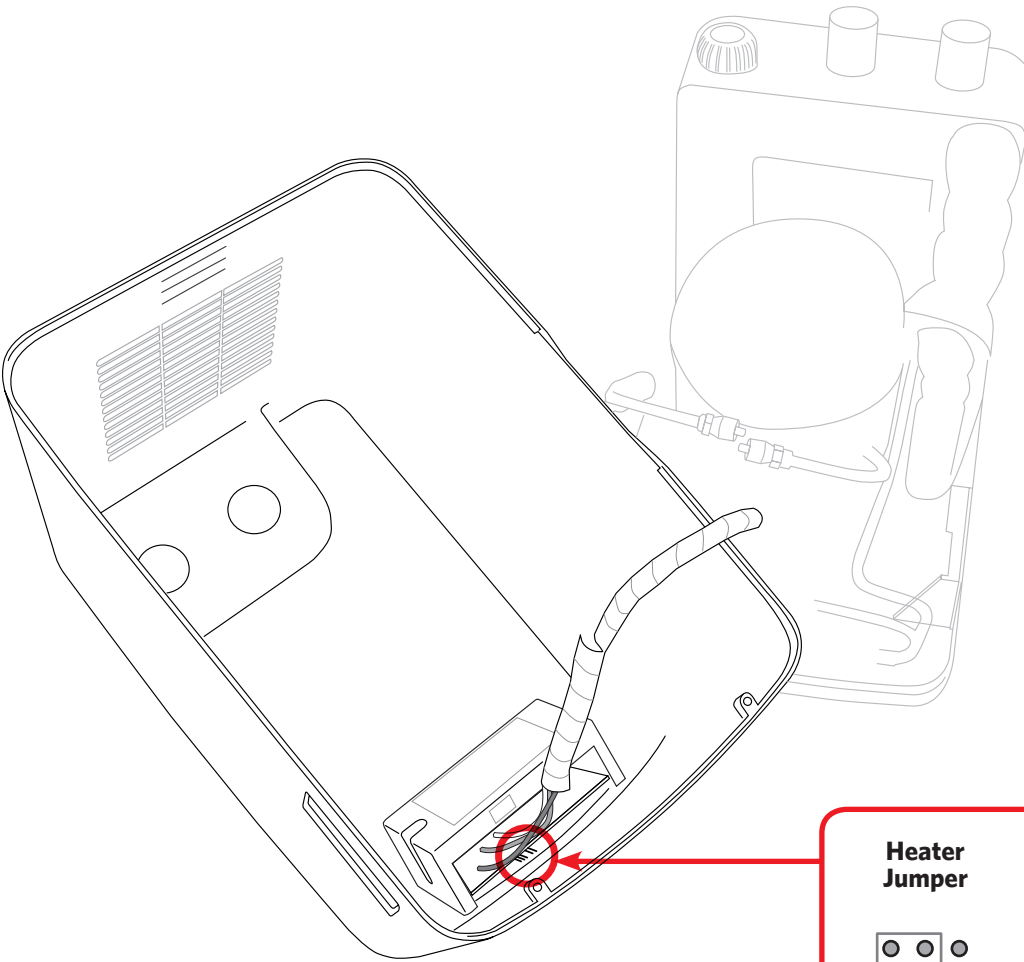

Heater Jumper	Reset Jumper	
		No Heater
		Heater Installed